

Dispositivi di sicurezza - Safety accessories - Средства обеспечения безопасности

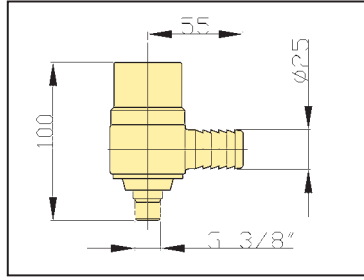

Valvola di sicurezza - Safety valve - Предохранительный клапан

6 BAR	24.3016.97.3
15 BAR	24.3016.97.3
18 BAR	24.3018.97.3
20 BAR	24.3020.97.3
40 BAR	24.3040.97.3
50 BAR	24.3050.97.3

Raccordi di montaggio - Mounting fittings - Монтажные фитинги

90° M/F	82.2044.50.2
"T" M/F/F	83.5020.00.2

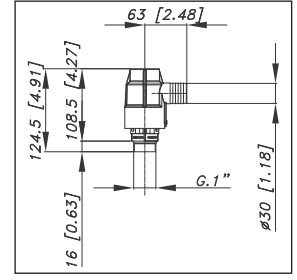

Valvola di sicurezza 400 - Safety valve 400 - Предохранительный клапан 400

CODICE	PRESSIONE	PORTATA		
	Bar	PSI	l/min	GPM
24.3110.97.3	10	145	400	105
24.3111.97.3	11	160	400	105
24.3112.97.3	12	174	400	105
24.3113.97.3	13	188	400	105
24.3114.97.3	14	203	400	105
24.3115.97.3	15	217	400	105

Per pompe di grande portata (fino a 400L/min.). Valvola a taratura variabile direttamente in fase d'installazione.

For pumps performing high flow rate (up to 400 l/min). It can be set directly during the installation.
Для насосов в повышенном расходе жидкости (до 400 л/мин.). Устанавливается непосредственно на выходной коллектор насоса.

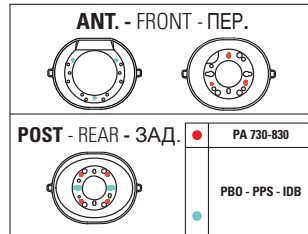

Cuffie di protezione - Safety cone - Защитные кожухи

Pompe Pumps - НАСОСЫ	Anteriore Front - ПЕРЕДНИЙ	Posteriore Rear - ЗАД.
POLY 2020-2025-2030 PA 330-430-440	31.1482.32.2	-
PA 530-730-830	31.1467.32.2	31.1482.32.2
PBO PPS	31.1466.32.2	31.1482.32.2
POLY 2073 - 2100	31.1468.32.2	31.1799.32.2
POLY 2180-2210-2240-2260-2300- 2400-2120-2150 - IDB	31.1482.32.2	31.1482.32.2
C 53 -75	31.1468.32.2	31.1468.32.2
CK 73-110-120- 146-220 CX 130 -150-150	31.1482.32.2	31.1482.32.2

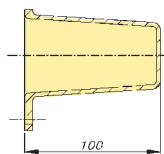

Cuffia di protezione posteriore P.D.F.

P.T.O. Cover
Защитные кожухи P.D.F.

POLY 2180-2210-2240-2260-2300 31.8898.97.3

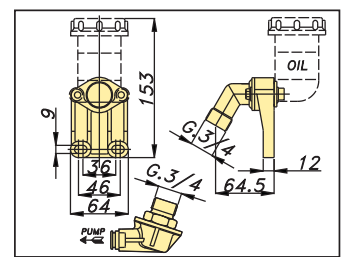

Serbatoio olio a distanza - Remote mounted oil tank - Выносной масляный бак

PA 530-730-830 PBO 1100-1250 POLY 2073-2120-2150-2210-2240 PPS 1211-1212	23.9823.973
PBO 1440-1540-1840 PPS 100-1613-1615 POLY 2180-2260-2300	23.9824.973